

AREA M <sup>2</sup>	224 09-02-2021 NOTARIA 3	ESCRITURA	MAT. INMOBILIARIA
403.93	SOGANOSO		095-158779

LOTE 1	277.53 M <sup>2</sup>
LOTE 2	126.40 M <sup>2</sup>
AREA TOTAL	403.93 M <sup>2</sup>

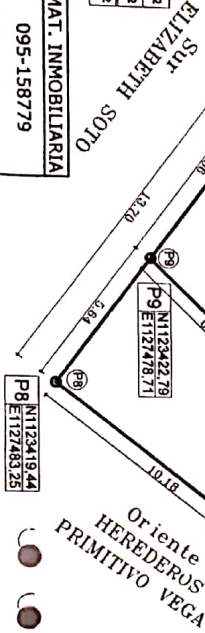

PUNTOS GEOREFERENCIALES DEL DESENGLOBE		
P1	N	1123447.35 E 1127489.65
P2	N	1123442.84 E 1127477.32
P3	N	1123449.11 E 1127481.41
P4	N	1123444.42 E 1127488.68
P5	N	1123441.16 E 1127493.73
P6	N	1123430.12 E 1127486.02
P7	N	1123427.44 E 1127489.54
P8	N	1123419.44 E 1127483.25
P9	N	1123427.58 E 1127472.23
P10	N	1123427.79 E 1127483.47
P11	N	1123428.88 E 1127487.51
P12	N	1123427.58 E 1127483.47
P13	N	1123433.37 E 1127475.69
P14	N	1123435.48 E 1127471.50
P15	N	1123437.21 E 1127472.04
P16	N	1123441.64 E 1127486.06

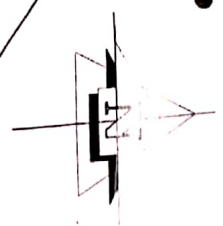

LOCALIZACIÓN

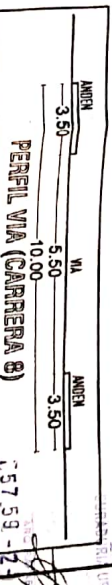

alfredo tobón p.   
 Calle 144 N. 15-17   
 SOGAMOSO

PROPIETARIOS:   
 GLADYS LUCERO ROJAS DE HERNANDEZ   
 NESTOR ORLANDO HERNANDEZ RODRIGUEZ

ARQUITECTO:   
 M.P. 25700-33838 CND   
 FECHA: MARZO 2021

ESCALA: 1-200